



Una van Jaarsveld
 Non-Principal Property Practitioner
 Registered with PPRA (FFC 115 789 4)
 0832824495
 una.van@kwsa.co.za

Contact Dolphin Coast

032 9461226

Douglas Crowe Drive, Ballito, 4420 - 14 Silverstone Way

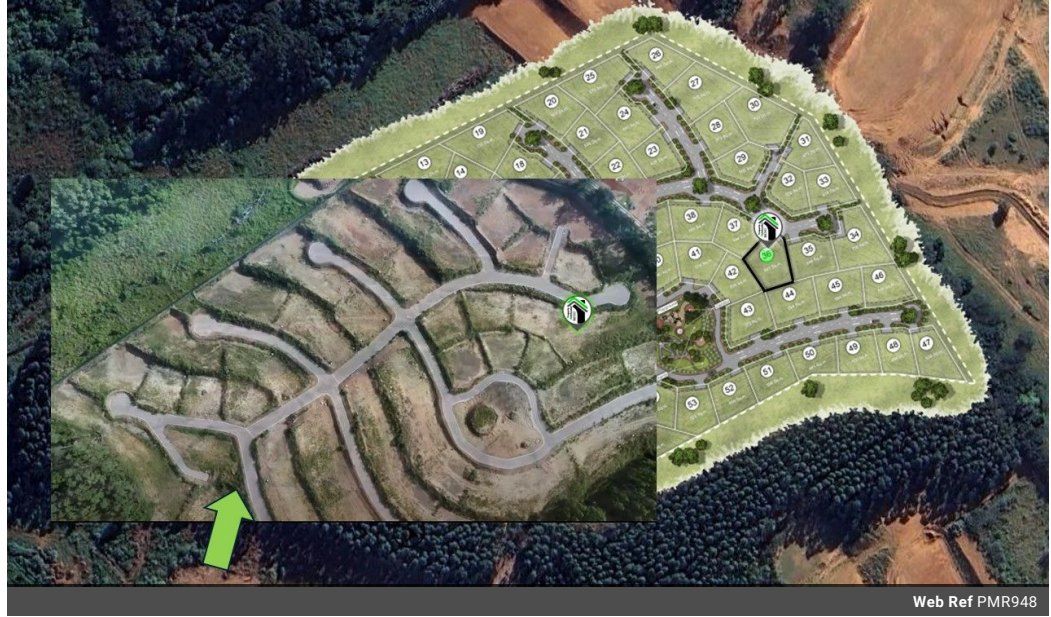

Web Ref PMR948



R1,157,000

Monthly Bond Repayment R11,942.42
 Calculated over 20 years at 11% with no deposit.

Transfer Costs R32,749.00 **Bond Costs** R25,220.00
 These calculations are only a guide. Please ask your conveyancer for exact calculations.

Monthly Levy R2,885 **Monthly Rates** R1,212

Embrace Nature Living In A Secure Estate

Witness your family's story unfold within the unique village of The Plantations, our latest site within Elaleni. Feel empowered to establish your family heritage along the undulating hills of Sheffield Beach. Your home at The Plantations will grant access to an edible landscape where you can have citrus espaliers along the streetscapes and handpick fruits and vegetables from the dedicated communal gardens.

You can work with your own architect and building team or utilize our development experts at Elaleni to make your dream home a reality.

Engaging Community Life

Designed to promote outdoor culture and unify people, Elaleni offers an array of facilities that deeply engage the senses. You can run along rugged trails, stroll through the forest boardwalk, and revel in the birdlife. You can also have a family day at the Leisure...

Features